

Michaels

How to Upload Dielines and Check Packaging Cost

within

CAPTURE[®]

If you have not already done so, please download and review the [3rd Party User Guide for Capture](#) before continuing.

How to Upload a Dieline File

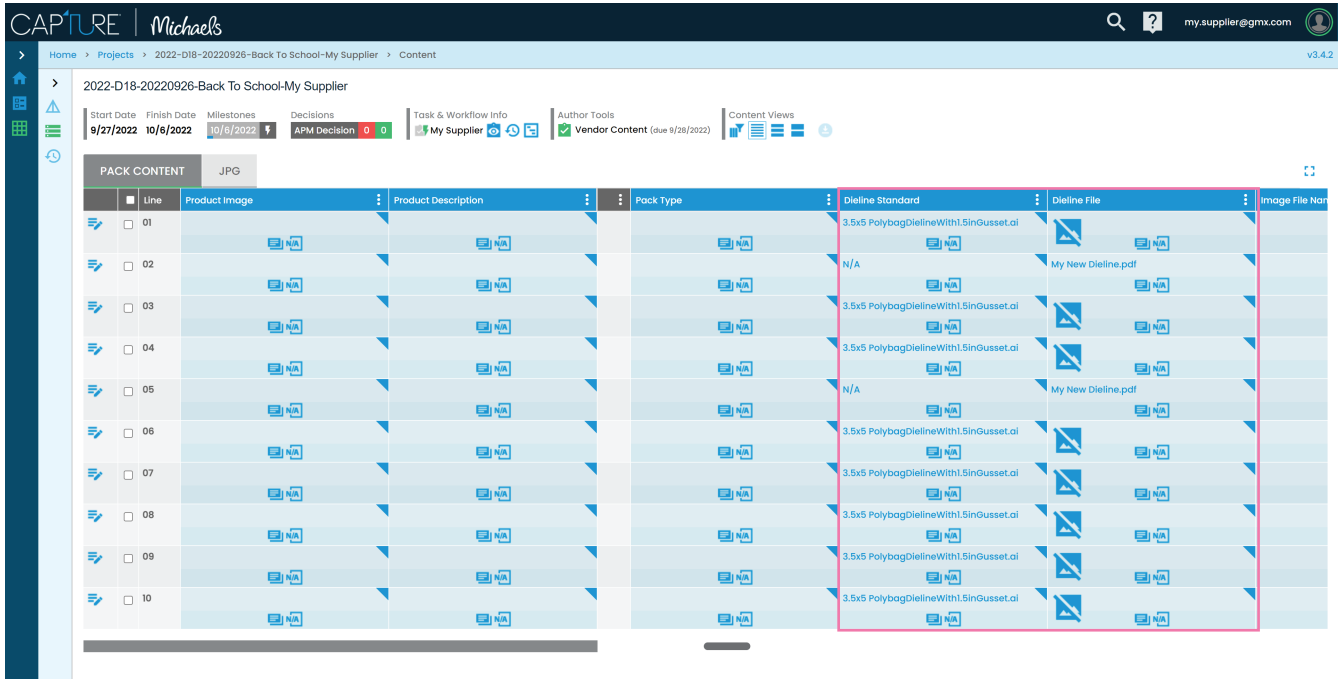

The pack content document within Capture has been configured with 2 columns to collect dielines:

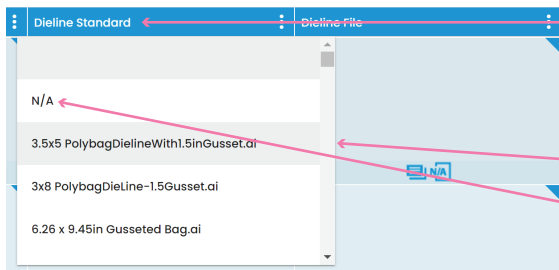

Dieline Standard

The cells in this column contain dropdown lists of all known dieline files.

Please select the appropriate option.

If you do not see the option you need, select or click 'N/A' then upload the correct file into the adjacent Dieline File cell.

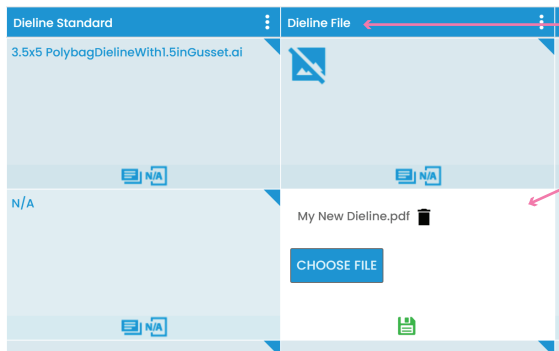

Dieline File

The cells in this column allow you to upload a dieline file.

Please only upload a dieline file here if you did not see the correct option within the adjacent Dieline Standard dropdown list.

Otherwise, click 'N/A'

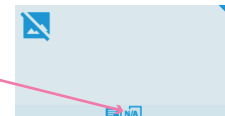

How to Check the Packaging Cost

Once the project is complete, review the costs on the JPG tab.

The screenshot shows the CAPTURE software interface for a project named "2023-D43-1111111-Halloween-my supplier". The interface includes a navigation bar with "Home", "Projects", and "Content" options. Below the navigation bar, there are tabs for "PACK CONTENT" and "JPG". The "JPG" tab is selected, and a table displays the following data:

| Line | Product Image | Product Description | Weight (g) | Substrate Weight Tolerance | Artwork Cost | Paid by |
|------|---|---------------------|------------|----------------------------|--------------|---------|
| 1 |  | Mini Pie Plate | | N/A | 200 | Vendor |

Three red arrows provide instructions:

- 1 - Click the JPG Tab
- 2 - Scroll to the far right
- 3 - Review the Artwork Cost and Paid by details.